

Project		Catalog #		Type	
Prepared by		Notes		Date	



Ephesus

LUMASPORT 8

White LED Sports & Entertainment Luminaire

Typical Applications

Pro Arenas • University & Collegiate Arenas • University & Collegiate Stadiums • Multi-Event & Convention Centers • Gymnasiums & Field Houses

Interactive Menu

- Dimensional Details [page 1](#)
- Ordering Information [page 2](#)
- Dimensional and Mounting Details [page 3](#)
- Visor (VHE) Configuration [page 4](#)
- Performance Data [page 5](#)
- Optical Performance Data [page 6](#)
- Ordering Information for Accessories [page 8](#)
- Accessory Dimensions and Part Details [page 9](#)
- Example System Topology [page 11](#)

Product Certification



Top Product Features

- 55,000 or 90,000 lumen output options
- Glare and cutoff control via Hybrid Reflector and TIR Optical System
- Reduce install time with pre-aimable two-piece assembly
- Virtually eliminate maintenance with power redundancy
- Industry leading light source reliability with Chip-on-Board LEDs
- Greater than 92% lumen maintenance at 55,000 hours
- Wired DMX or Wireless AirMesh controls options to suit your needs

Dimensional Details

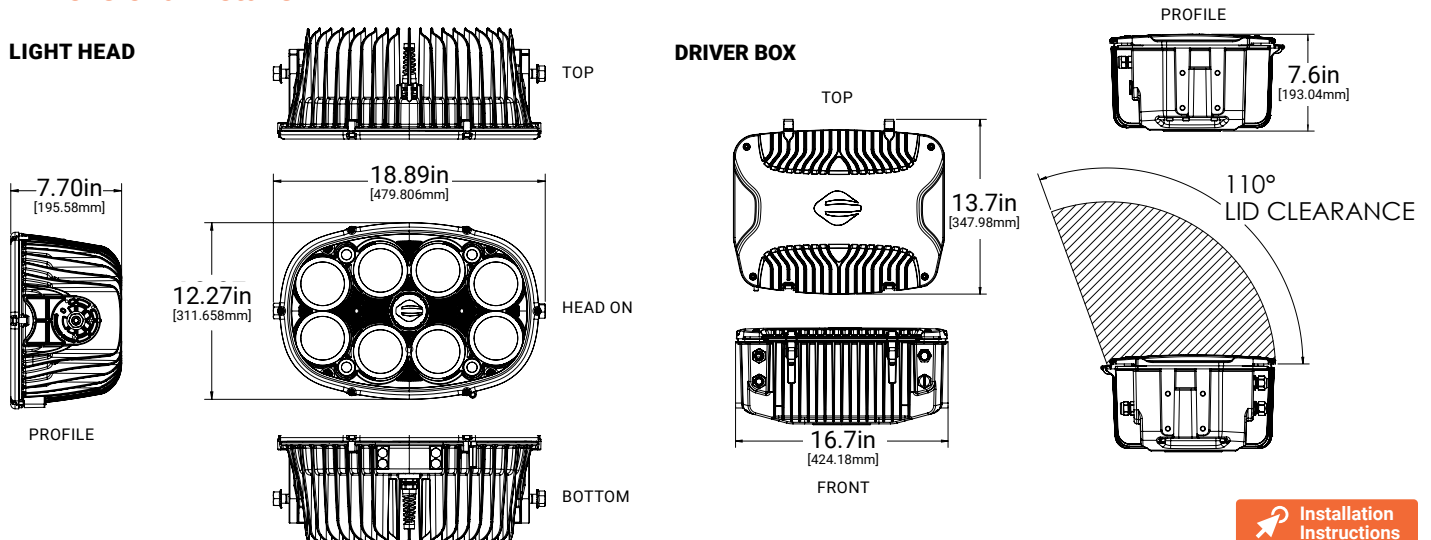

[Installation Instructions](#)

Order Information

NOTE: A complete fixture order requires a selection entry for **Brand, Family, Model, Power Configuration, Color, CCT, CRI, Optic, Light Head Cable (DC), Voltage, Control, Mount Configuration, Power Cable (AC), Options, Packaging, & International Option.**

SAMPLE ORDER NUMBER: EPH-LS-08-0320L-BLK-40-70-1S-C04-HV-LB-LY-A00-HEG-BP-ST

Brand	Family	Model	Power Configuration	Color	CCT	CRI	Optic	Light Head Cable (DC)
Brand	Family	Model	Power Configuration	Color ²	CCT	CRI	Optic ³	Light Head Cable (DC) ⁴
EPH = Ephesus	LS = Lumasport	08 = 8 Optics	0320L = 320W Local Power ¹ 0640L = 640W Local Power ¹	BLK = Black WHT = White	40 = 4000K 50 = 5000K 57 = 5700K	70 = 70 CRI 80 = 80 CRI	1S = NEMA 3 17.5 33.3 2S = NEMA 3 21.9 40.2 3S = NEMA 3 25.4 45.7 4S = NEMA 4 36.0 64.4 5S = NEMA 5 46.6 82.6 7F = NEMA 7 72.5 131.0	C04 = 4ft Cable, Standard C10 = 10ft Cable, Catwalk
			Notes: (1) Local Power means that the light head is attached to the driver box with the yoke or pendant mount.	Notes: (2) Not coastal rated. Contact Ephesus for coastal fixture options.			Notes: 7F = NEMA 7 Optic only available with 0320L = 320W Local Power configuration. (3) Optic = NEMA TYPE; BEAM ANGLE; FIELD ANGLE. Additional optical performance data within spec sheet.	Notes: (4) DC Cable connecting the light head to the driver box.

Voltage	Control	Mount Configuration	Power Cable (AC)	Options	Packaging	International Option
Voltage	Control	Mount	Power Cable (AC)	Options	Packaging	International Option
LV = Low Voltage HV = High Voltage	AM = Wireless AirMesh LB = Wired DMX NC = No Control	LY = Local Yoke LP = Local Pendant	A00 = Standard, No Cable A04 = 4ft Cable A10 = 10ft Cable A15 = 15ft Cable	HEG = No Visor High Efficiency Glass Lens VHE = Visor High Efficiency Glass Lens	BP = Bulk Pack UP = Unit Packaging	ST = Standard
			Notes: (6) AC Cable connecting the Driver Box to the electrical power source.			

Dimensional and Mounting Details

MOUNTING: DRIVER BOX

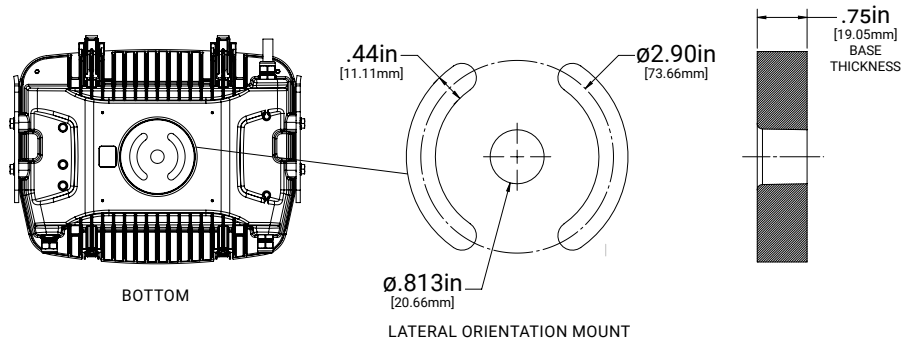

MOUNTING CONFIGURATION: LOCAL YOKE

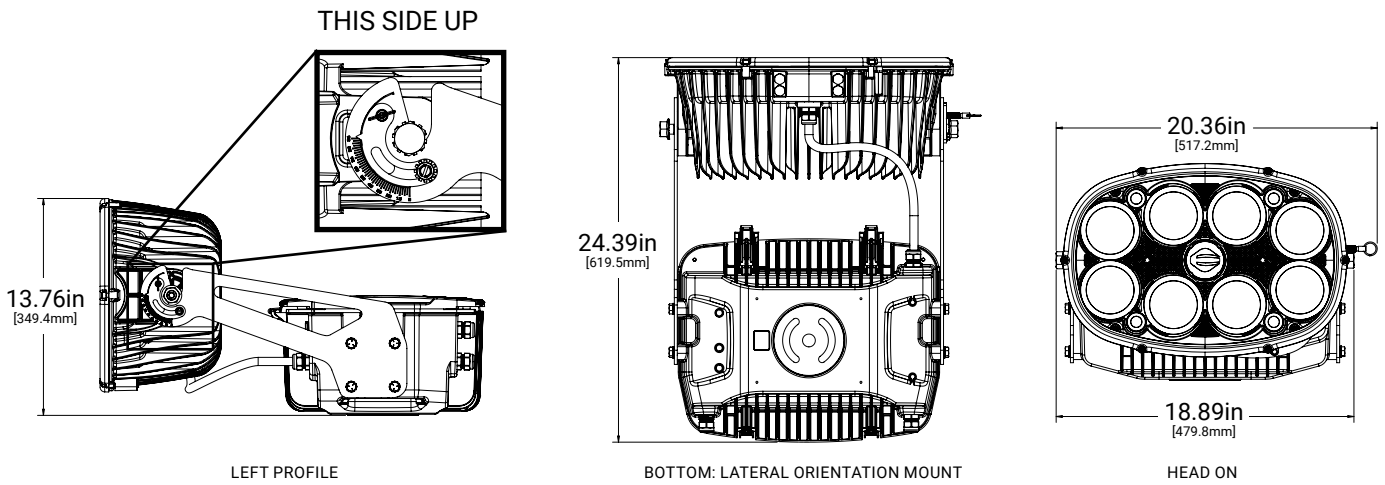

MOUNTING CONFIGURATION: LOCAL PENDANT

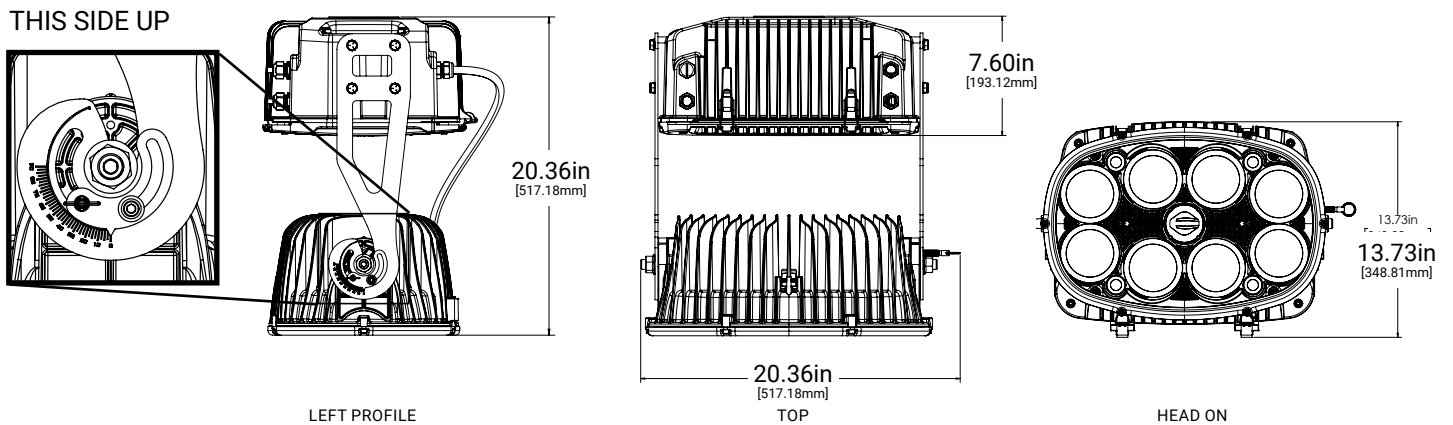

VHE Visor Option

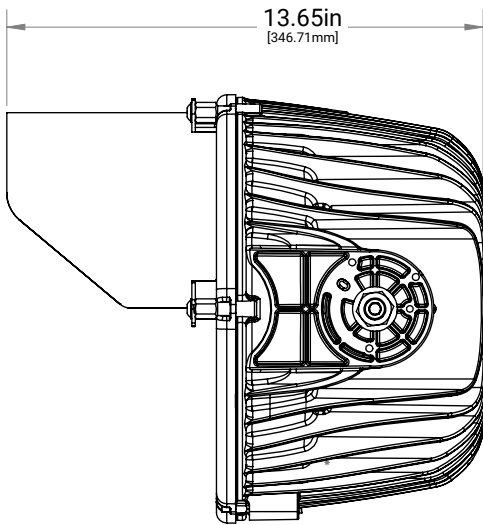

LEFT PROFILE: VISOR

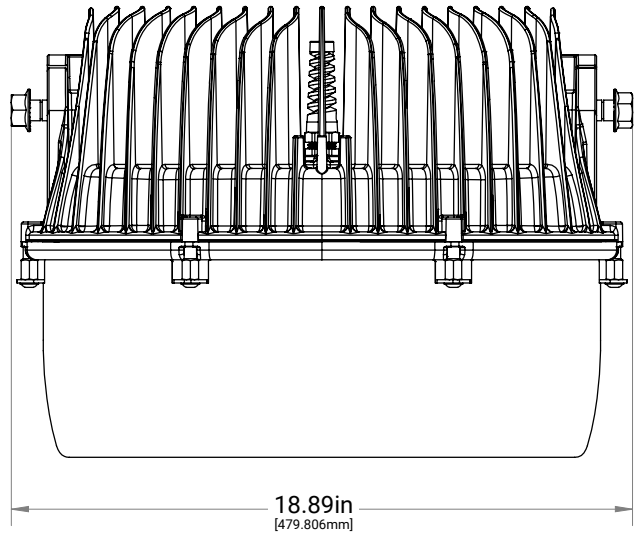

TOP: VISOR

NOTES:

The addition of a visor adds 1lb of material to the luminaire weight.

Performance Data¹

	LUMASPORT 8 (320W)	LUMASPORT 8 (640W)
Lumen Output Range ²	48,303 - 55,419lm	80,572 - 92,929lm
Nominal Power ³	340W	680W
Input Voltage (Low Voltage)	120-277VAC	120-277VAC
Input Voltage (High Voltage)	347-480VAC	347-480VAC
Efficacy Range ²	140.4 - 163.5 lm/W	117.5 - 139.3 lm/W
CRI ⁴	70, 80	70, 80
TLCI ⁵	75	75
CCT Range	4000K, 5000K, 5700K	4000K, 5000K, 5700K
Distribution (NEMA)	3-5, 7	3-5
Dimming Range	DIM TO OFF, 10%-100%	DIM TO OFF, 10%-100%
Operating Temperature Range	-40°C to +40°C	-40°C to +40°C
Usage	INDOOR, OUTDOOR ⁶	INDOOR, OUTDOOR ⁶
Mounting Options (3G RATED)	LOCAL YOKE; LOCAL PENDANT	LOCAL YOKE; LOCAL PENDANT
Electrical Certifications	FCC, UL8750, UL1598, DLC Standard (NANQSV)	FCC, UL8750, UL1598, DLC Standard (NANQSV)
Environmental Certifications	ANSI C136.31-2010 3G, IP66, NEMA4X ⁷	ANSI C136.31-2010 3G, IP66, NEMA4X ⁷
Surge	10kV	10kV
Effective Projected Area (EPA)	1.8 (sq. ft.)	1.8 (sq. ft.)
Effective Projected Area (EPA) with Visor (VHE) ⁸	1.8 - 2.5 (sq. ft.)	1.8 - 2.5 (sq. ft.)
Approximate Weight ⁹	67.5 LBS	71.5 LBS

NOTES:

- (1) Specifications are subject to change without notice.
- (2) Refer to Optical Performance Data.
- (3) Values are +/- 4% when fixture is operated at 25°C ambient
- (4) Values are +/- 2%
- (5) Values are +/- 3 points.
- (6) When driver box is mounted in upright position.
- (7) Light head meets NEMA4X Certification
- (8) EPA may vary depending on the aiming angle of the fixture.
- (9) Weight may vary depending on mounting bracket, VHE Visor option, light head and driver box selection.

Optical Performance Data (HEG Configuration Option)

LUMASPORT 8 (320W) Lumen Outputs								
Optic	NEMA TYPE	CRI	CCT	Lumens	Input Power (W)	Lm/W	Beam Angle	Field Angle
1S	NEMA 3	70	4000K	53987	346	156.0	17.5	33.3
			5000K	54903	346	158.7	17.5	33.3
			5700K	53943	346	155.9	17.5	33.3
		80	4000K	50877	346	147.0	17.5	33.3
			5000K	51822	346	149.8	17.5	33.3
			5700K	50916	346	147.2	17.5	33.3
2S	NEMA 3	70	4000K	54494	339	160.7	21.9	40.2
			5000K	55419	339	163.5	21.9	40.2
			5700K	54450	339	160.6	21.9	40.2
		80	4000K	51346	339	151.5	21.9	40.2
			5000K	52308	339	154.3	21.9	40.2
			5700K	51400	339	151.6	21.9	40.2
3S	NEMA 3	70	4000K	53275	344	154.9	25.4	45.7
			5000K	54179	344	157.5	25.4	45.7
			5700K	53232	344	154.7	25.4	45.7
		80	4000K	50200	344	145.9	25.4	45.7
			5000K	51137	344	148.7	25.4	45.7
			5700K	50209	344	146.0	25.4	45.7
4S	NEMA 4	70	4000K	53419	344	155.3	36.0	64.4
			5000K	54325	344	157.9	36.0	64.4
			5700K	53375	344	155.2	36.0	64.4
		80	4000K	50335	344	146.3	36.0	64.4
			5000K	51275	344	149.1	36.0	64.4
			5700K	50344	344	146.3	36.0	64.4
5S	NEMA 5	70	4000K	54338	344	158.0	46.6	82.6
			5000K	55260	344	160.6	46.6	82.6
			5700K	54294	344	157.8	46.6	82.6
		80	4000K	51202	344	148.8	46.6	82.6
			5000K	52158	344	151.6	46.6	82.6
			5700K	51211	344	148.9	46.6	82.6
7F	NEMA 7	70	4000K	51262	344	149.0	72.5	131.0
			5000K	52132	344	151.5	72.5	131.0
			5700K	51220	344	148.9	72.5	131.0
		80	4000K	48303	344	140.4	72.5	131.0
			5000K	49205	344	143.0	72.5	131.0
			5700K	48312	344	140.4	72.5	131.0

LUMASPORT 8 (640W) Lumen Outputs								
Optic	NEMA TYPE	CRI	CCT	Lumens	Input Power (W)	Lm/W	Beam Angle	Field Angle
1S	NEMA 3	70	4000K	85498	686	124.6	17.5	33.3
			5000K	88248	686	128.6	17.5	33.3
			5700K	86402	686	126.0	17.5	33.3
		80	4000K	80572	686	117.5	17.5	33.3
			5000K	83295	686	121.4	17.5	33.3
			5700K	81554	686	118.9	17.5	33.3
2S	NEMA 3	70	4000K	90033	667	135.0	21.9	40.2
			5000K	92929	667	139.3	21.9	40.2
			5700K	90985	667	136.4	21.9	40.2
		80	4000K	84832	667	127.2	21.9	40.2
			5000K	87713	667	131.5	21.9	40.2
			5700K	85888	667	128.8	21.9	40.2
3S	NEMA 3	70	4000K	88702	681	130.3	25.4	45.7
			5000K	91555	681	134.4	25.4	45.7
			5700K	89640	681	131.6	25.4	45.7
		80	4000K	83582	681	122.7	25.4	45.7
			5000K	86415	681	126.9	25.4	45.7
			5700K	84550	681	124.2	25.4	45.7
4S	NEMA 4	70	4000K	88659	681	130.2	36.0	64.4
			5000K	91510	681	134.4	36.0	64.4
			5700K	89596	681	131.6	36.0	64.4
		80	4000K	83541	681	122.7	36.0	64.4
			5000K	86372	681	126.8	36.0	64.4
			5700K	84508	681	124.1	36.0	64.4
5S	NEMA 5	70	4000K	89953	681	132.1	46.6	82.6
			5000K	92846	681	136.3	46.6	82.6
			5700K	90904	681	133.5	46.6	82.6
		80	4000K	84761	681	124.5	46.6	82.6
			5000K	87633	681	128.7	46.6	82.6
			5700K	85742	681	125.9	46.6	82.6

Optical Performance Data (VHE Visor Configuration Option)

LUMASPORT 8 (320W) Lumen Outputs								
Optic	NEMA TYPE	CRI	CCT	Lumens	Input Power (W)	Lm/W	Beam Angle	Field Angle
1S	NEMA 3	70	4000K	50557	346	146.1	18.3	33.0
			5000K	51415	346	148.6	18.3	33.0
			5700K	50516	346	146.0	18.3	33.0
		80	4000K	47645	346	137.7	18.3	33.0
			5000K	48530	346	140.3	18.3	33.0
			5700K	47681	346	137.8	18.3	33.0
2S	NEMA 3	70	4000K	51545	339	152.1	22.5	38.8
			5000K	52420	339	154.6	22.5	38.8
			5700K	51504	339	151.9	22.5	38.8
		80	4000K	48568	339	143.3	22.5	38.8
			5000K	49478	339	146.0	22.5	38.8
			5700K	48619	339	143.4	22.5	38.8
3S	NEMA 3	70	4000K	50127	344	145.7	25.7	44.3
			5000K	50977	344	148.2	25.7	44.3
			5700K	50086	344	145.6	25.7	44.3
		80	4000K	47234	344	137.3	25.7	44.3
			5000K	48115	344	139.9	25.7	44.3
			5700K	47242	344	137.3	25.7	44.3
4S	NEMA 4	70	4000K	50235	344	146.0	35.1	63.7
			5000K	51087	344	148.5	35.1	63.7
			5700K	50193	344	145.9	35.1	63.7
		80	4000K	47334	344	137.6	35.1	63.7
			5000K	48218	344	140.2	35.1	63.7
			5700K	47343	344	137.6	35.1	63.7
5S	NEMA 5	70	4000K	49723	344	144.5	44.5	80.5
			5000K	50567	344	147.0	44.5	80.5
			5700K	49683	344	144.4	44.5	80.5
		80	4000K	46854	344	136.2	44.5	80.5
			5000K	47728	344	138.7	44.5	80.5
			5700K	46862	344	136.2	44.5	80.5
7F	NEMA 7	70	4000K	43036	344	125.1	66.7	121.6
			5000K	43767	344	127.2	66.7	121.6
			5700K	43001	344	125.0	66.7	121.6
		80	4000K	40552	344	117.9	66.7	121.6
			5000K	41309	344	120.1	66.7	121.6
			5700K	40560	344	117.9	66.7	121.6

LUMASPORT 8 (640W) Lumen Outputs								
Optic	NEMA TYPE	CRI	CCT	Lumens	Input Power (W)	Lm/W	Beam Angle	Field Angle
1S	NEMA 3	70	4000K	80066	686	116.7	18.3	33.0
			5000K	82642	686	120.5	18.3	33.0
			5700K	80913	686	117.9	18.3	33.0
		80	4000K	75453	686	110.0	18.3	33.0
			5000K	78003	686	113.7	18.3	33.0
			5700K	76373	686	111.3	18.3	33.0
2S	NEMA 3	70	4000K	85162	667	127.7	22.5	38.8
			5000K	87901	667	131.8	22.5	38.8
			5700K	86062	667	129.0	22.5	38.8
		80	4000K	80242	667	120.3	22.5	38.8
			5000K	82967	667	124.4	22.5	38.8
			5700K	81241	667	121.8	22.5	38.8
3S	NEMA 3	70	4000K	83460	681	122.6	25.7	44.3
			5000K	86145	681	126.5	25.7	44.3
			5700K	84343	681	123.9	25.7	44.3
		80	4000K	78643	681	115.5	25.7	44.3
			5000K	81309	681	119.4	25.7	44.3
			5700K	79554	681	116.8	25.7	44.3
4S	NEMA 4	70	4000K	83374	681	122.4	35.1	63.7
			5000K	86055	681	126.4	35.1	63.7
			5700K	84255	681	123.7	35.1	63.7
		80	4000K	78561	681	115.4	35.1	63.7
			5000K	81223	681	119.3	35.1	63.7
			5700K	79470	681	116.7	35.1	63.7
5S	NEMA 5	70	4000K	82314	681	120.9	44.5	80.5
			5000K	84961	681	124.8	44.5	80.5
			5700K	83184	681	122.1	44.5	80.5
		80	4000K	77563	681	113.9	44.5	80.5
			5000K	80191	681	117.8	44.5	80.5
			5700K	78460	681	115.2	44.5	80.5

Ordering Information for Accessories

NOTE: A complete accessory order requires a selection entry for **Brand, Accessory, Option**.

SAMPLE ORDER NUMBER: **EPH-HRDM34-025**

Brand	Accessory	Option	
Brand	Accessory	Option	Intended Use
EPH = Ephesus	DVGBRD = Diving Board ¹		Designed to be used with the LUMASPORT 8, LUMASPORT 16 & LUMADAPT 8 luminaires only.
	HRDM34 = Mounting Hardware 3/4in diameter	025 = .25in ² 075 = .75in ² 200 = 2in ²	HRDM34-025: .25-.50in clamping thickness, use for diving board (DVGBRD) or other flat surfaces drilled for 3/4 hardware HRDM34-075: .50-.75in clamping thickness, flat surfaces drilled for 3/4 hardware HRDM34-200: 2.00in clamping thickness, use for 2in x 4in Cross arms that are drilled for 3/4 hardware
	Notes: (1) Additional mounting fastener hardware kit needed to attach a fixture to the DVGBRD = Diving Board	Notes: (2) Option only available for use with HRDM34	

Diving Board (DVGBRD) Dimension and Part Details:

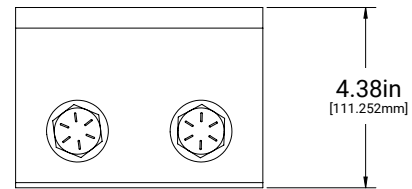
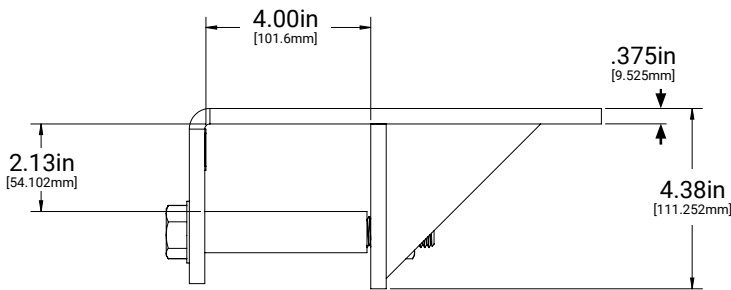
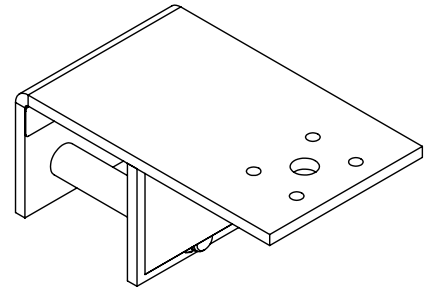
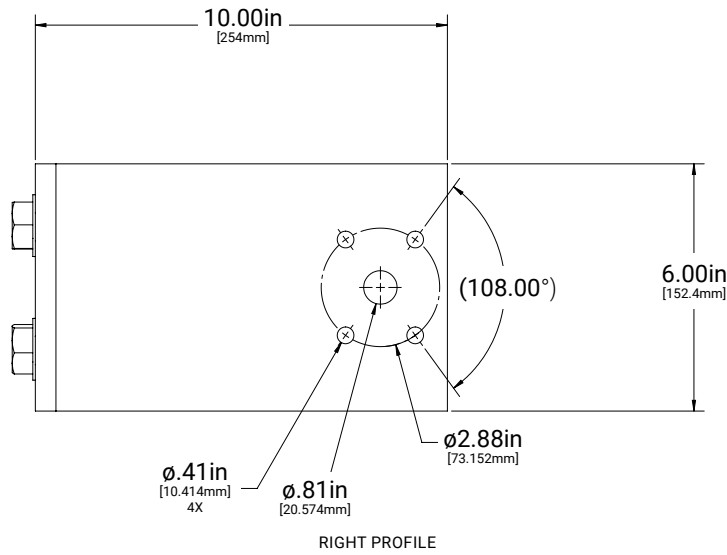

Diving Board Data

MODEL #	WEIGHT (LBS)
DVGBRD	15.1
DVGBRD + HRDM34-025	16.1

Diving Board Parts

DESCRIPTION	QUANTITY
Welded Bracket	1
Bolt Sleeve	2
3/4in-10 X 6in Structural Hex Bolt, Hot Dip Galvanized	2
3/4in Steel Flat Washer, Hot Dip Galvanized	2
3/4in Ext Tooth Washer, Steel, Magni-565 Grey Polycoat	2
3/4in-10 Structural Steel Hex Nut, Hot Dip Galvanized	2
Stainless Shim	1

HRDM34 Dimension and Part Details:

HRDM34-025:

.25-.50in clamping thickness, use for diving board (DVGBRD) or other flat surfaces drilled for 3/4 hardware

HRDM34-075:

.50-.75in clamping thickness, flat surfaces drilled for 3/4 hardware

HRDM34-200:

2.00in clamping thickness, use for 2inx4in Cross arms that are drilled for 3/4 hardware

HRDM34 Data

MODEL #	WEIGHT (LBS)
HRDM34-025	1
HRDM34-075	1.5
HRDM34-200	2

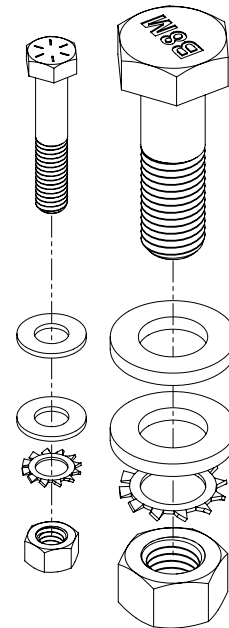
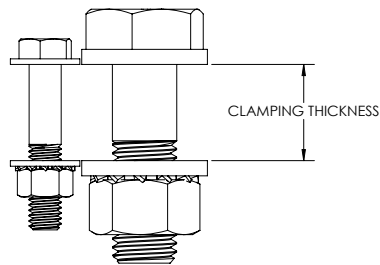

Example System Topology (Wired DMX Controls)

Example system topology showing the LUMASPORT 8 System in a commonly used wired DMX Control Installation. Refer to the specifications and limitations of your wired DMX control device before installing this configuration.

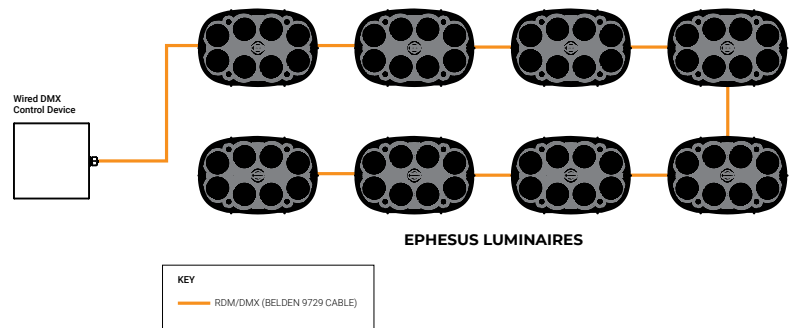

Example System Topology (Remote Access Point With Wired DMX Controls)

Example system topology showing the LUMASPORT 8 System in a commonly used remote access point with wired DMX Control Installation. Refer to the specifications and limitations of your wired DMX control device before installing this configuration. Note: Laptop or mobile device not included. A cellular network connection requires a cellular carrier network plan.

REMOTE ACCESS POINT TO DMX SYSTEM CONTROLS

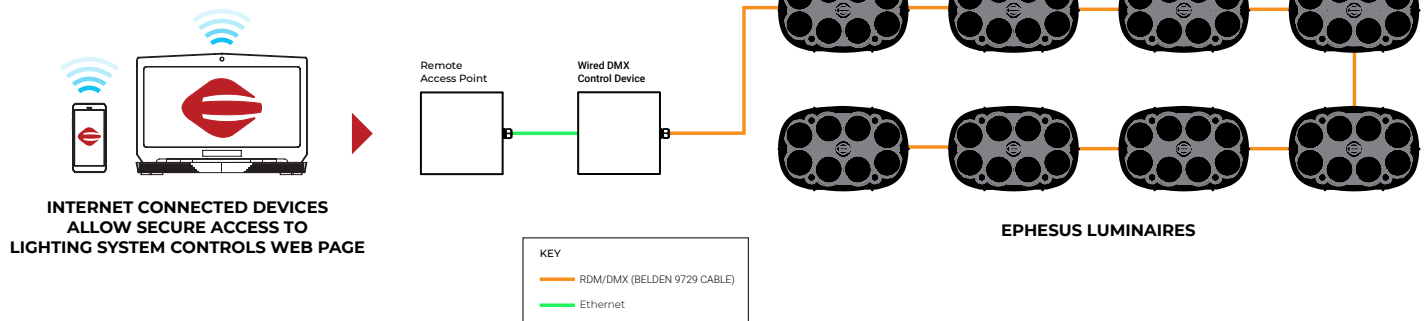

NOTES:

Remote Access Point requires either a wired Internet connection at the lighting system site or through a cellular carrier network connection plan.

Example System Topology (Contactor Controls)

Example system topology showing the LUMASPORT 8 System in a Wired Contactor Controls Installation.

Note: Laptop or mobile device not included. A cellular network connection requires a cellular carrier network plan.

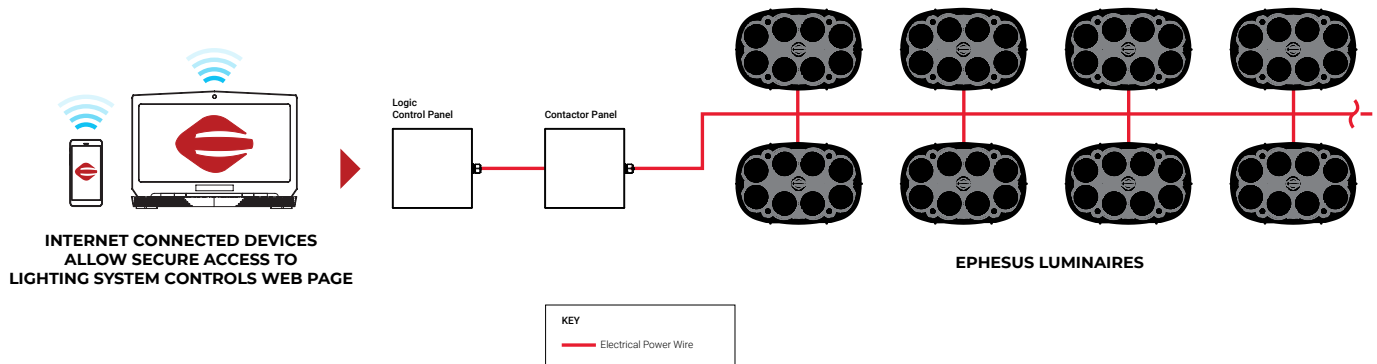

Example System Topology (Wireless AirMesh Controls)

Example system topology showing the LUMASPORT 8 System in a Wireless AirMesh Control Installation.

Note: Laptop or mobile device not included. A cellular network connection requires a cellular carrier network plan.

